



# FOR LEASE

## ±16,000 SF INDUSTRIAL SPACE

1 Brozzini Court, Suite H  
Greenville, SC 29615



LEE & ASSOCIATES  
GREENVILLE/SPARTANBURG

**Randall Bentley, SIOR, CCIM**  
President/Managing Principal  
864.444.2842  
rbentley@lee-associates.com

**Micah Williams**  
Senior Vice President  
864.477.0455  
mwilliams@lee-associates.com

**Whit Traweek**  
Associate  
864.813.2977  
wtraweek@lee-associates.com

**864.704.1040**  
LeeUpstate.com

Interactive PDF



### PRICING/RATE:

**\$10.50 / SF  
(NNN)**

- 3 Docks; 2 Pit Levelers
- Clear Height 24'
- Office ±1,600 SF
- End cap of building



**I-85**  
±1 Mile from I-85



**POWER**  
800a, 480v, 3p



**MAJOR ACCESS**  
Less than a mile from  
Pelham Rd



**SPRINKLER**  
ESFR

# PROPERTY OVERVIEW & PHOTOS

PROPERTY NAME	Brozzini One
TYPE	Industrial
TOTAL BUILDING SF	±128,000 SF
TOTAL AVAILABLE SF	±16,000 SF
OFFICE SF	±1,600 SF
WAREHOUSE SF	±14,400 SF
TAX MAP #	0533020100941
COUNTY	Greenville
CITY LIMITS	No
ZONING	I-1; GSP Env
YEAR BUILT	1997
CONSTRUCTION TYPE	Reinforced Concrete
ROOF	Metal
CEILING HEIGHT	24'
DOCK DOORS	Three (3); Two (2) Pit Levelers
DRIVE-IN DOORS	Zero (0)
COLUMN SPACING	40'w x 40'd
LIGHTING	Metal Halide
SPRINKLERS	ESFR
PARKING	1.26 / 1,000 SF



Interactive PDF 

201 W. McBee Ave, Suite 400, Greenville, SC 29601  
320 E. Main Street, Suite 430, Spartanburg, SC 29302  
[LeeUpstate.com](http://LeeUpstate.com) | 864.704.1040



# FLOOR PLAN

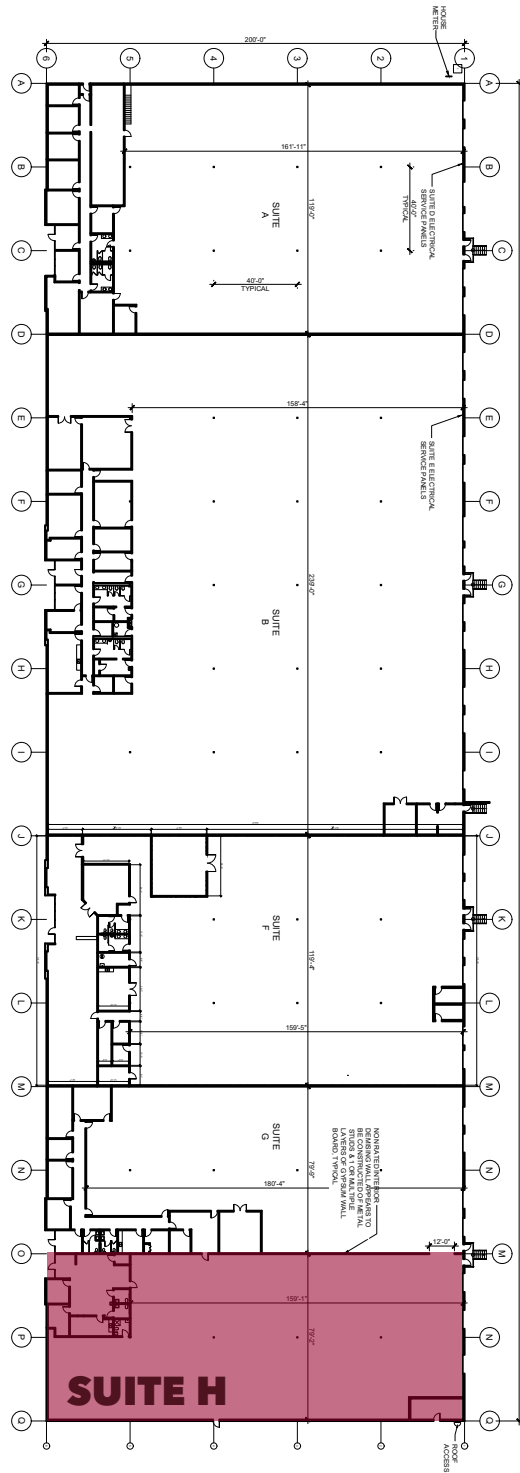

# LOCATION OVERVIEW



[Click Here to View the Interactive Map](#)

Interactive PDF 

201 W. McBee Ave, Suite 400, Greenville, SC 29601  
320 E. Main Street, Suite 430, Spartanburg, SC 29302  
[LeeUpstate.com](http://LeeUpstate.com) | [864.704.1040](tel:864.704.1040)



Interactive PDF 

**LEARN MORE  
CALL TODAY**



LEE & ASSOCIATES  
GREENVILLE/SPARTANBURG

**864.704.1040**  
**LeeUpstate.com**

**GREENVILLE OFFICE**  
201 W. McBee Ave, Suite 400  
Greenville, SC 29601

**SPARTANBURG OFFICE**  
320 E. Main Street, Suite 430  
Spartanburg, SC 29302

All information furnished regarding the properties and information in this packet is from sources deemed reliable, but no warranty or representation is made to the accuracy thereof and same is submitted to errors, omissions, change of price, rental or other conditions prior to sale, lease or financing or withdrawal without notice. No liability of any kind is to be imposed on the broker herein.



**Randall Bentley, SIOR, CCIM**  
President/Managing Principal  
864.444.2842  
rbentley@lee-associates.com



**Micah Williams**  
Senior Vice President  
864.477.0455  
mwilliams@lee-associates.com



**Whit Traweek**  
Associate  
864.813.2977  
wtraweek@lee-associates.com