

117 Standing Springs Road

Greenville, SC 29605

Property Features

- Excellent Location near SCTAC (Donaldson Center)
- Standing Seam Metal Roof
- 6", 4000 PSI Unreinforced Concrete Slab Foundation
- 20' Ceiling Height at Eaves
- (1) 9' x 10' Dock Door
- (1) 12' x 14' Drive In Door
- Mechanical Edge of Dock Leveler
- LED High Bay Interior Lighting
- LED Wall pack Exterior Lighting
- EH2 Sprinkler System
- 480/277 Volt Power and 120/208V 200 A House Panel
- Septic System
- Available Q4 2025
- \$12.00/SF/YR

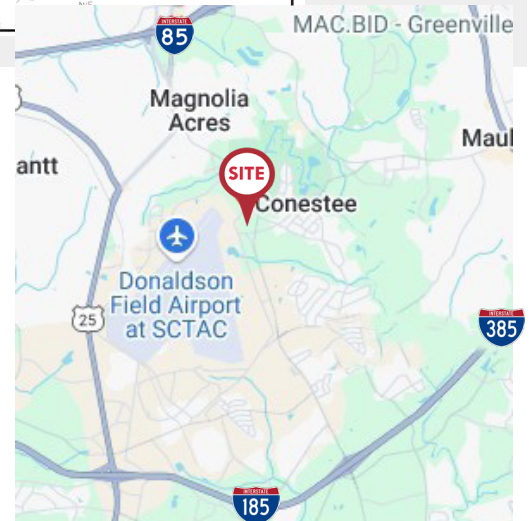

For more information:

Hunter Garrett
864-505-6813 | hgarrett@naief.com

John Staunton
864-905-1112 | johnstaunton@naief.com

Josh Kenyon
704-964-2181 | jkenyon@naief.com

The information contained herein is deemed reliable but is not guaranteed. NAI Earle Furman makes no warranties or representations regarding the accuracy, completeness, or reliability of the information. All parties are encouraged to independently verify all details, including but not limited to property condition, terms, and financial projections. Prices, terms, and availability are subject to change without notice.

101 East Washington St, Suite 400
Greenville, SC 29601
864-232-9040

naiearlefurman.com

For Lease
Proposed ±15,200 SF
Manufacturing/
Distribution Space

Building Site



Floorplan

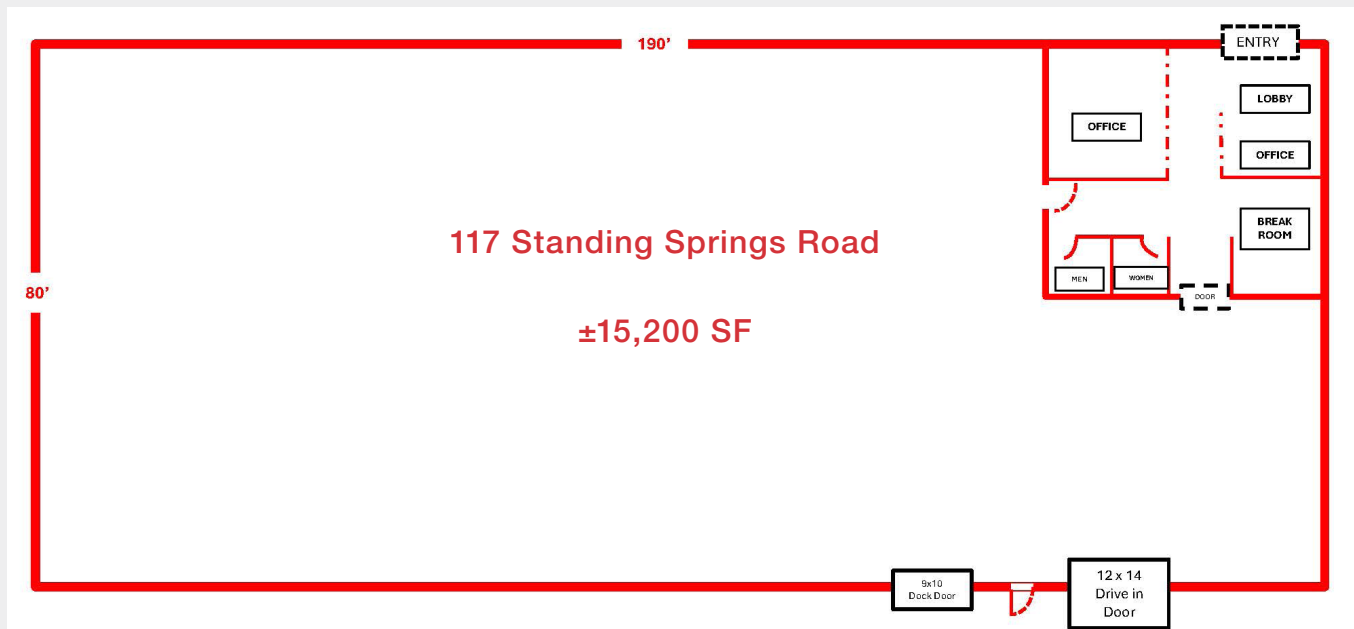

Not to scale, for illustration purposes only