



WILLIMON
BUSINESS PARK

Building A

25 Barnes Trail, Greenville, SC 29605



224,640 SF AVAILABLE - FOR LEASE

Contact Broker for Pricing

CBRE

Collett
INDUSTRIAL



GTIS PARTNERS

Site Plan

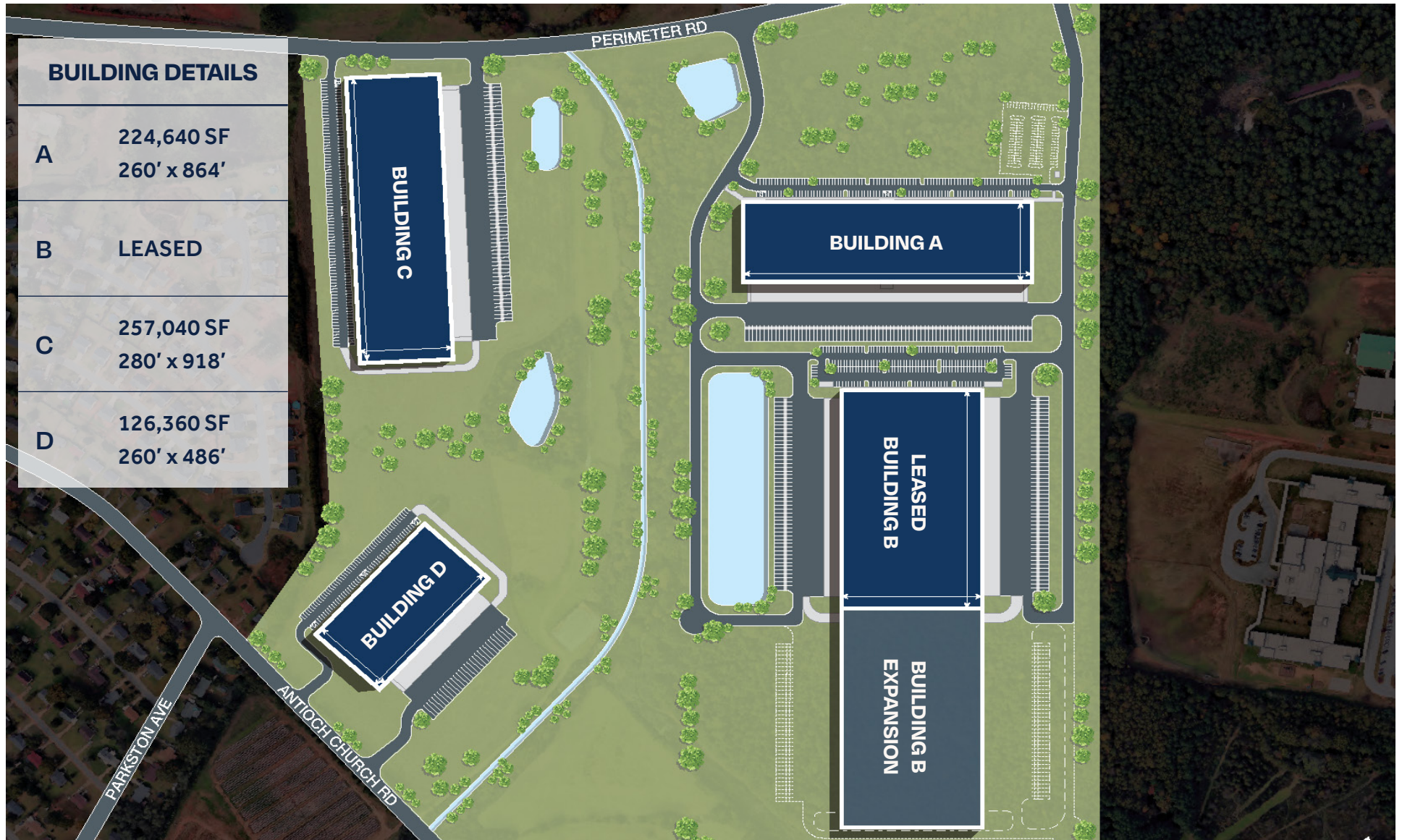

Building A Floor Plan

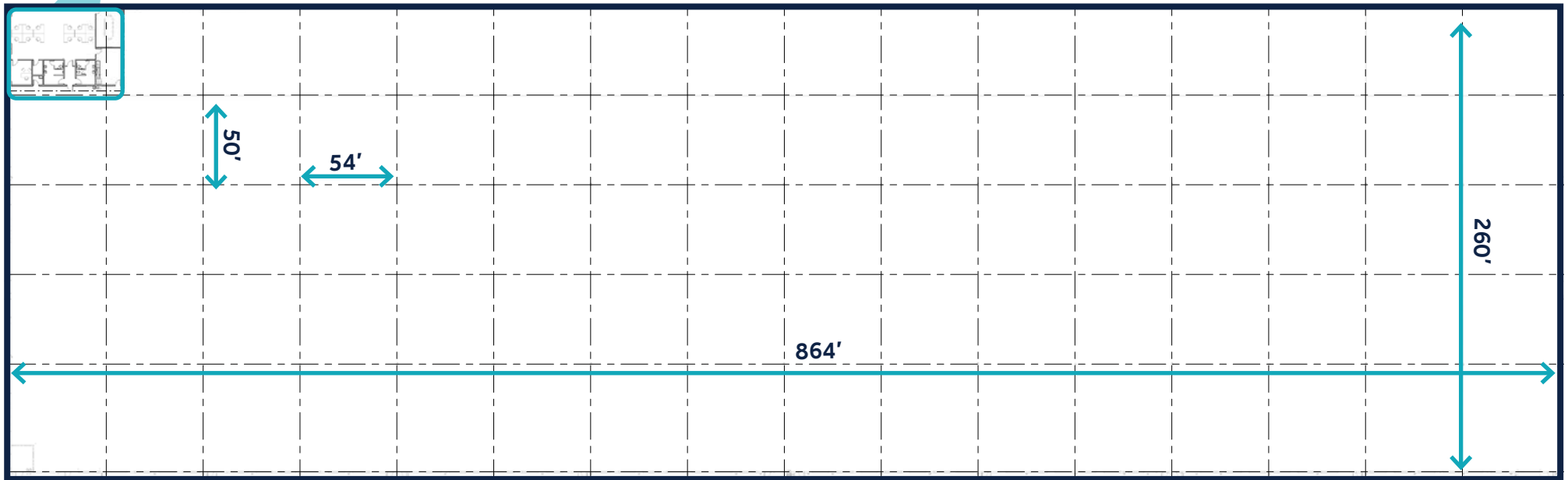
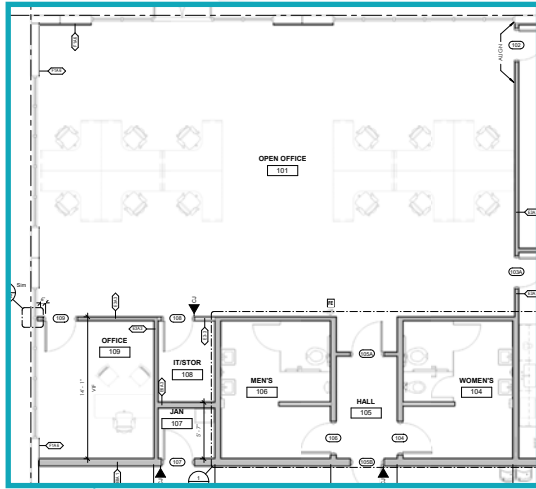

Building A Details



Building Size: ±224,640 SF



Spec Office: ±2,600 SF



Building Dimensions: 260' x 864'



Column Spacing: 50' x 54'
(60' Speed Bay)



Clear Height: 32'



Dock Doors: 48 (9' x 10')



Dock Packages: 4 (40k LB mechanical levelers)



Drive-In Doors: 2 (12' x 14')



Flooring: 6", 4000 psi



Fire Protection: ESFR



Lighting: 10 FC, LED, 36K lumens,
motion sensor, one fixture per bay



Auto Parking: 175



Trailer Parking: 72



Roof: TPO, Single Ply Membrane, 45
MIL TPO, R-20



Truck Court: 185'



Power: 2000 amps

Building A Divisibility

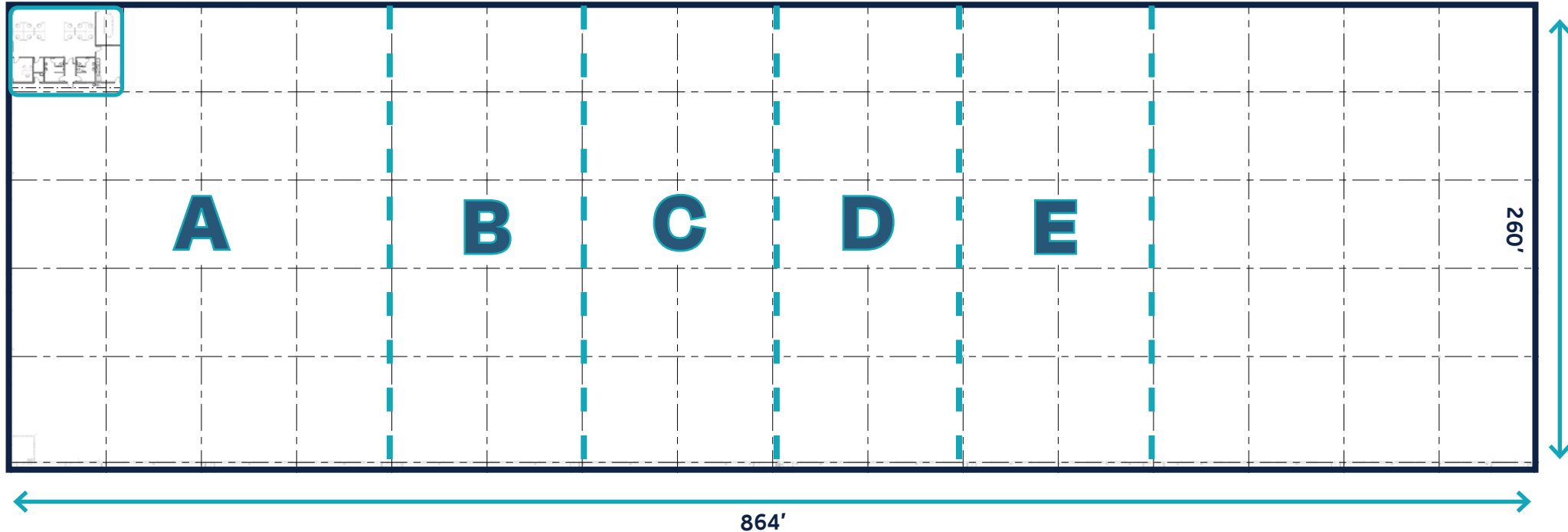

Option A	Option B	Option C	Option D	Option E	Full Building
Size: ±56,160 SF	Size: ±84,240 SF	Size: ±112,320 SF	Size: ±140,400 SF	Size: ±168,480 SF	Size: ±224,640 SF
Bays: 4	Bays: 6	Bays: 8	Bays: 10	Bays: 12	Bays: 16
Dock Doors: 10	Dock Doors: 16	Dock Doors: 23	Dock Doors: 30	Dock Doors: 36	Dock Doors: 48
Drive-In Doors: 1	Drive-In Doors: 1	Drive-In Doors: 1	Drive-In Doors: 1	Drive-In Doors: 1	Drive-In Doors: 2

Surrounding Tenants

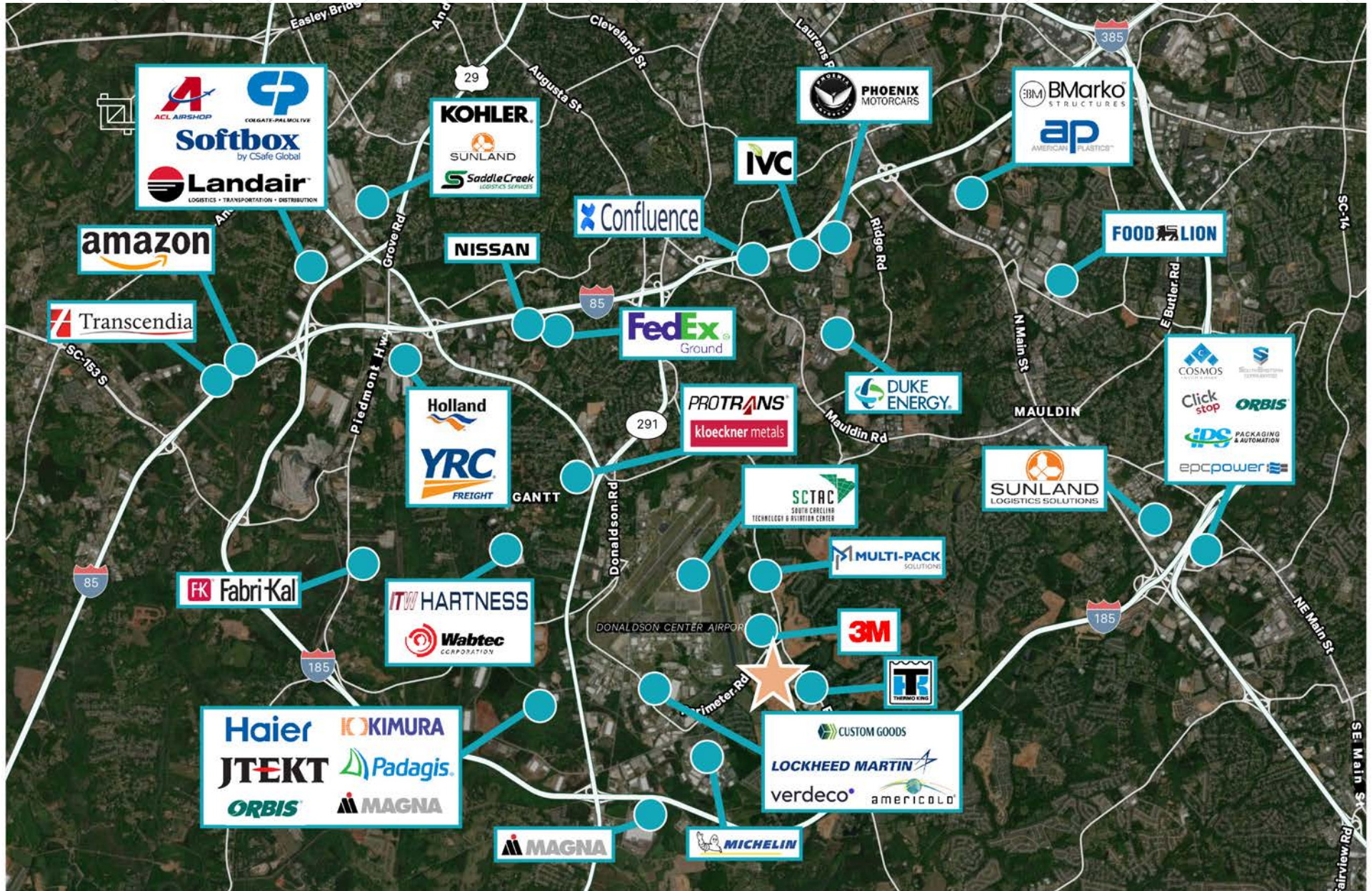

Labor & Demographics

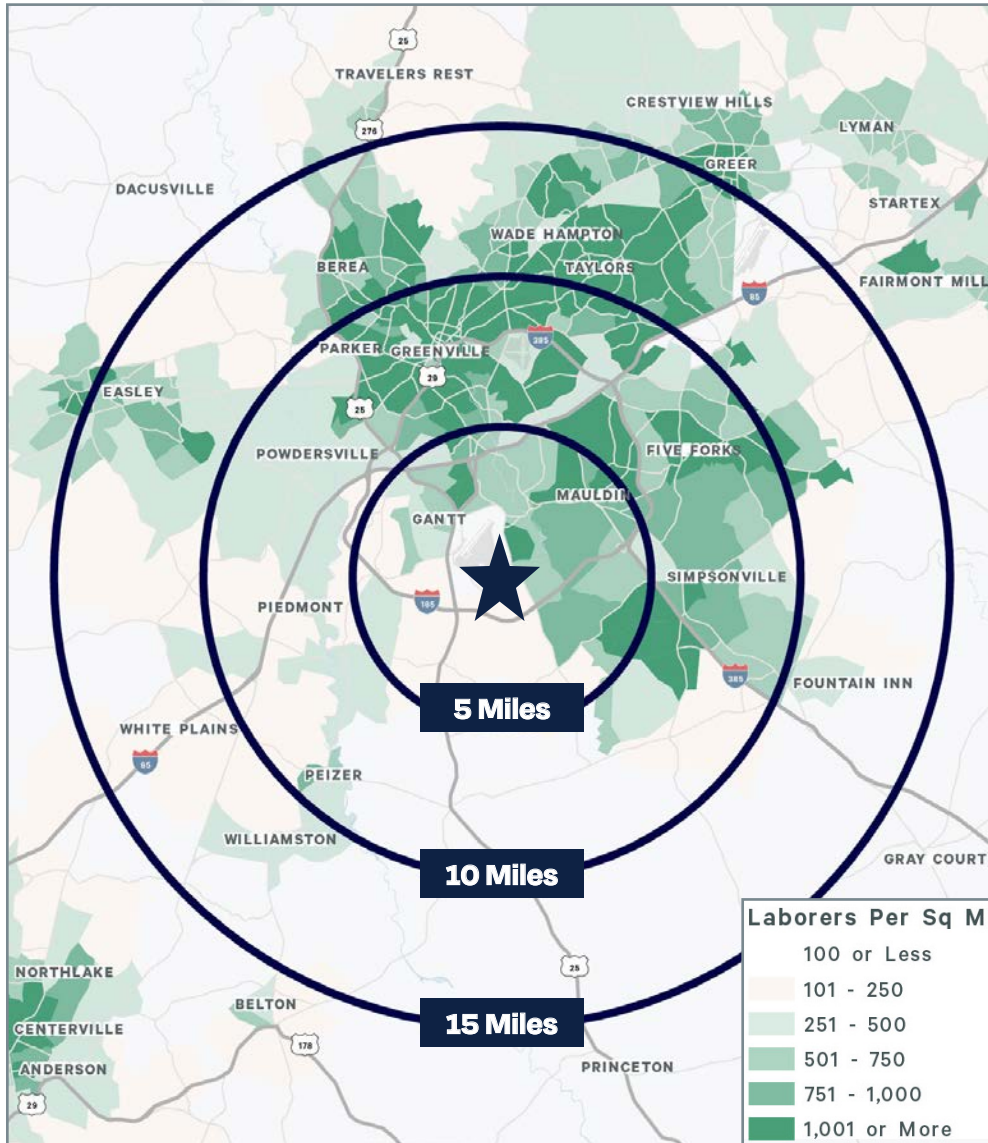

LOCATION	DISTANCE
Donaldson Airport	0.1 Miles
I-185	2.0 Miles
I-385	6.2 Miles
I-85	7.0 Miles
Downtown Greenville	8.4 Miles
GSP Airport	16.8 Miles

	5 MILES	10 MILES	15 MILES
POPULATION	80,047	363,550	302,349
DAYTIME POPULATION	78,063	426,144	642,972
BUSINESSES	2,216	16,601	22,620
LABOR FORCE	41,260	186,762	304,342
BACHELOR'S DEGREE OR HIGHER	11,119	67,073	106,379
AVERAGE HH INCOME	\$92,362	\$105,048	\$103,278

Drive Time Map

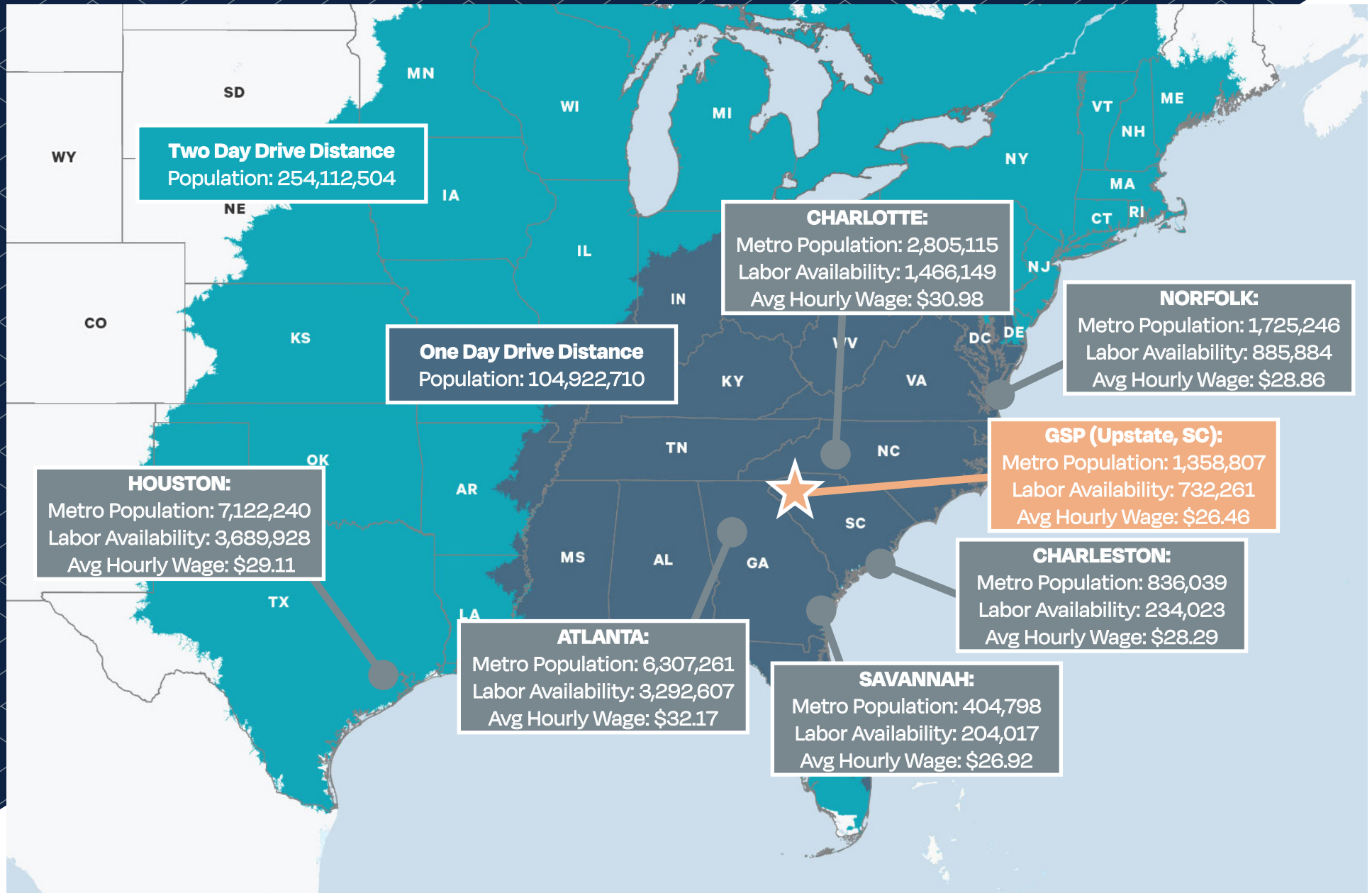



Contact Us:

Trey Pennington, SIOR
Executive Vice President
+1 864 527 6095
trey.pennington@cbre.com

Jeff Benedict, SIOR
Vice President
+1 864 235 1961
jeff.benedict@cbre.com

Tripp Speaks
Associate
+1 864 235 6196
tripp.speaks@cbre.com